

# PINOUT

## Quick Start Setup Guide (Android User)

Version 1.0

Zesty Systems Inc.

2016.7.19

## Index

Introduction of Pinout.....	3
Pinout hardware overview .....	4
Camera compatibility .....	4
Connect Pinout to your DSLR .....	6
Quick start of application .....	7
User profile and upgrade your kit .....	12
Technical Support .....	14

# Introduction of Pinout

Pinout is a small device that plugs to your DSLR camera; it uses Bluetooth LE technology and a dedicated app on your smartphone to give you remote access and much more to the camera.

The main functions of Pinout are as follows

- ✧ Simple release
- ✧ Long exposure
- ✧ Timed release
- ✧ Time lapse
- ✧ Distance lapse
- ✧ Star trail
- ✧ Geo tagging
- ✧ Geo logging
- ✧ Bulb ramping
- ✧ LE HDR
- ✧ LE HDR time lapse
- ✧ Loss prevention
- ✧ Sensor release

# Pinout hardware overview

Pinout does not require batteries and uses a very tiny portion of camera's charge. It seamlessly blends in with camera. No cable, does not use hot shoe, and no need to take it off before stowing away camera in camera bag.

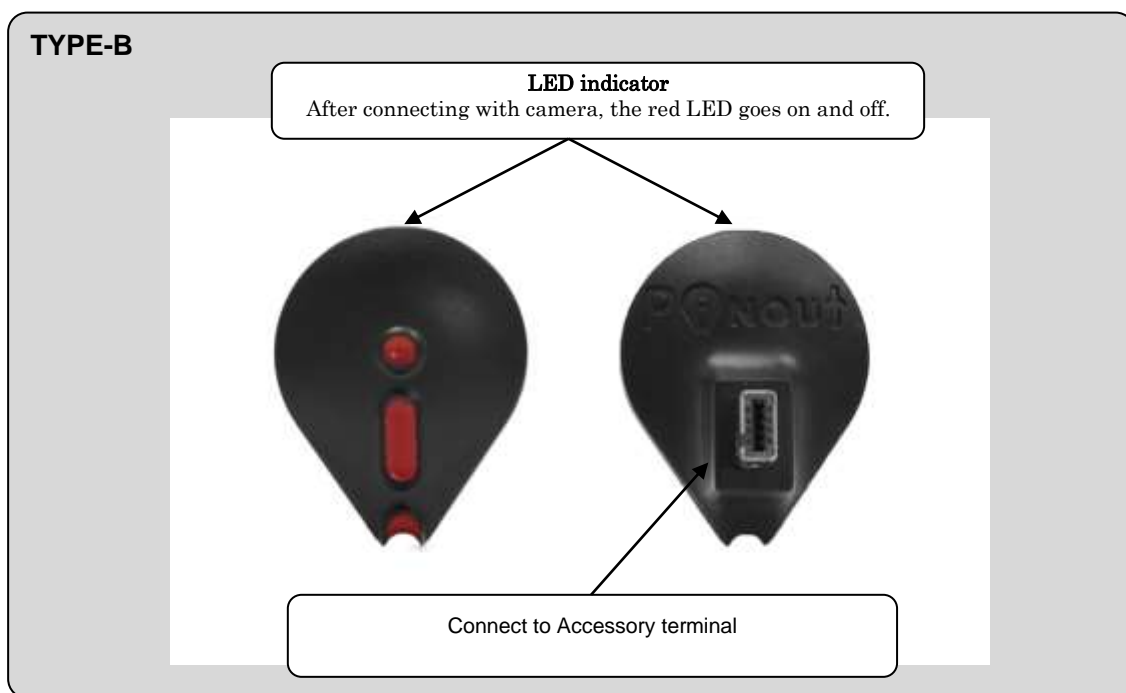

## Camera compatibility

Pinout includes type A and type B. Please confirm your digital camera models before purchase

Type	DSLR Models
Type A	Nikon D5, D500, D4, D4s, D3, D3S, D3X, D2X, D2XS, D2HS, D2H, D800, D800E, D810, D810A, D700, D300, D300S, D200 and Fujifilm S5 Pro
Type B	Nikon Df, D750, D610, D600, D90, D7200, D7100, D7000, D5500, D5300, D5200, D5100, D5000, D3300, D3200, D3100, COOLPIX A, COOLPIX P7800, COOLPIX P7700;

## Connect Pinout to your DSLR

Turn off your camera and connect to remote-control interface of the camera

Connect Pinout to your DSLR by easily friction fit the port (please don't screw otherwise the interface or Pinout maybe damaged).



TYPE-A



TYPE-B

## Quick start of application

Step 1. Power on the camera

Step 2. Check the installation of smart phone software

If the application is not installed on your smart phone, please download as follows.

- ✧ For iPhone users: please download Pinout App from apple store (Free)
- ✧ For Android users: please refer to the latest information of our HP.

Step 3. Set Bluetooth before starting the application

The products can't work without starting Bluetooth. Please start Bluetooth as follows.

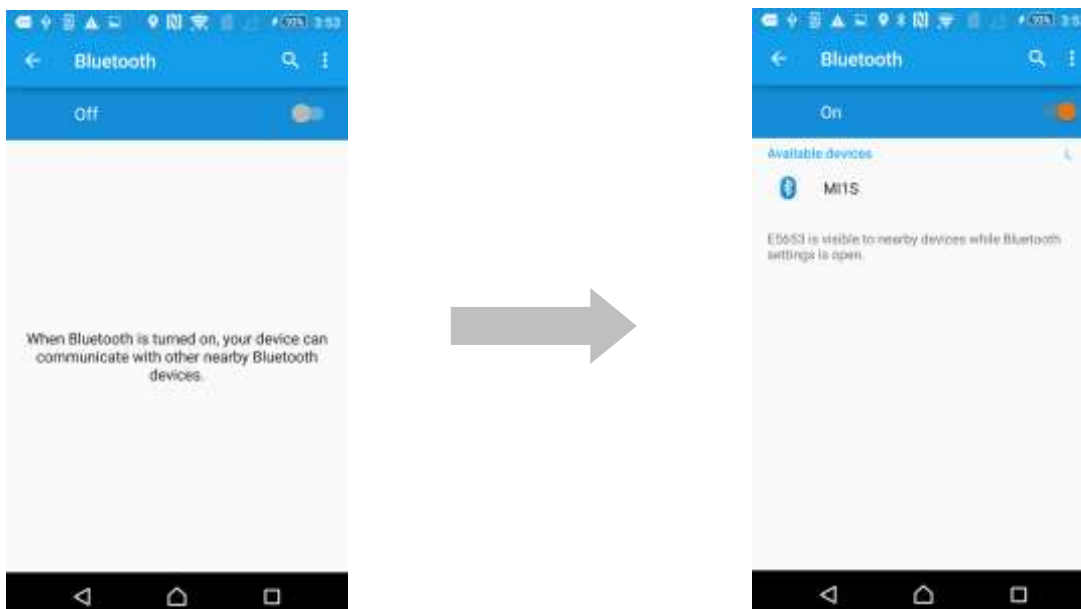

Step 4. Start Pinout app

Start Pinout application. If it is the first time your start Pinout app, you will see following.



The registration page of Pinout app

Step 5 user registration and Pinout kit setting or login

If you are a new user please choose new user and register as following. Or login.



Register a new user



After you registered as a new user you need to choose the kit you purchased.

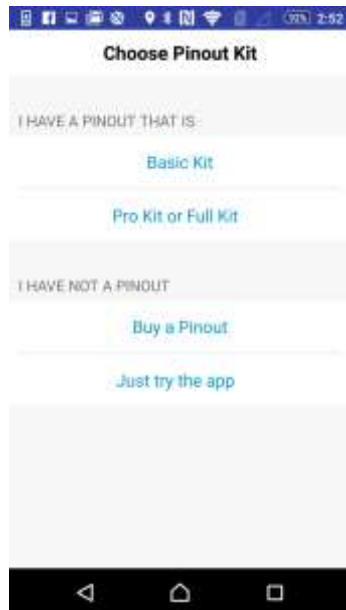

Choose the Pinout kit you purchased

If you purchased a pro kit or a full kit, you need to tear off the seal and scan the QR code printed on the warranty card or input the passcode manually. When the scan is finished, your registration is done and you are ready to use Pinout.

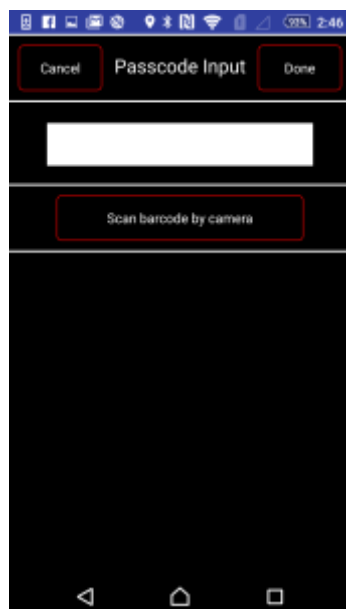

QR code scan to register to a pro or full kit user

### Step 6. Connect Pinout to your DSLR

Tap the camera icon on top-right screen, Pinout app will start to search DSLRs (or click find cameras button) and give out a list, tap the right DSLR you want to connect to Pinout app.

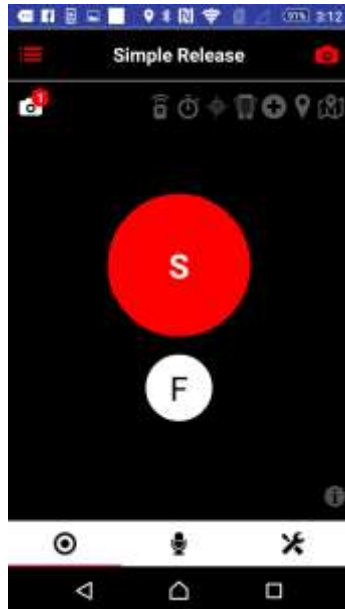

Tap top-right camera icon



Discover the DSLR nearby



Connect the right DSLR to Pinout app

#### Step 7. Shooting

Click back to the main screen, and press the red S button to start shooting.

## User profile and upgrade your kit

User information (name, photo, phone number) can be updated when you click on the user name.

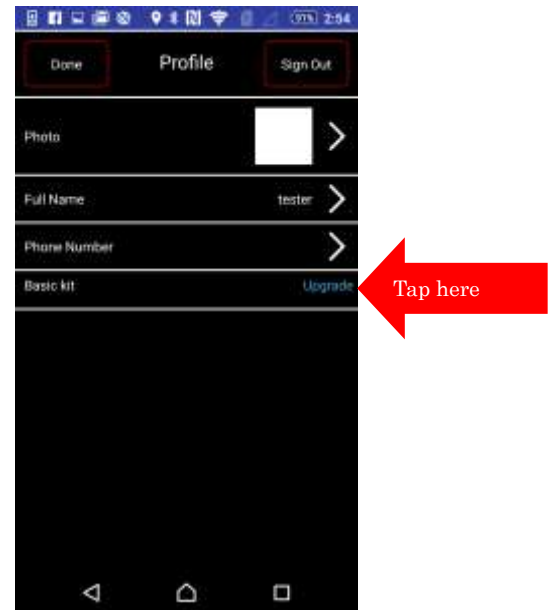
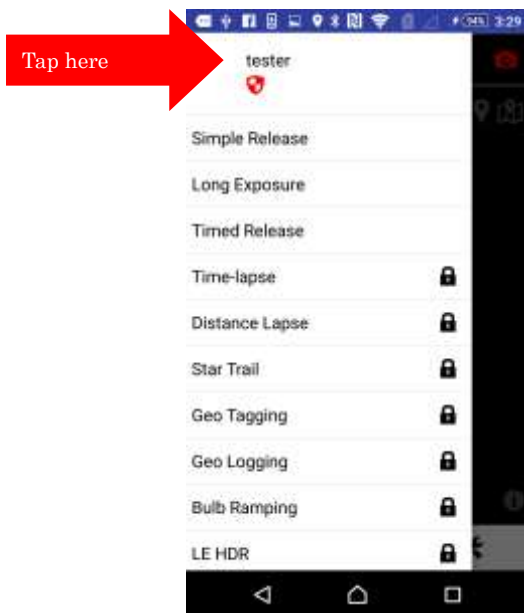

The status of your kit is shown in the profile, you can upgrade your kit by tapping on the kit status.



Step1 After you tap on the current kit name, you will get the screen below

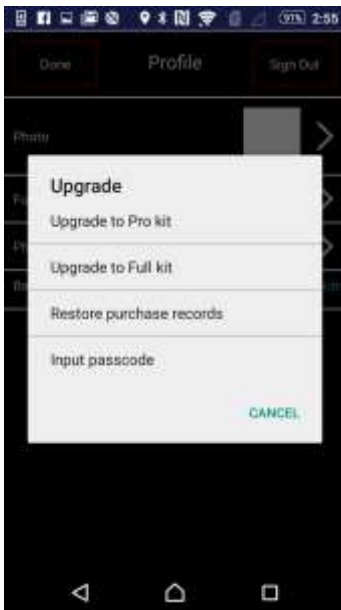

If you choose “upgrade to Pro kit” or “upgrade to Full kit”, you will get a popup message to ask you to sign in itunes store to purchase the kit.

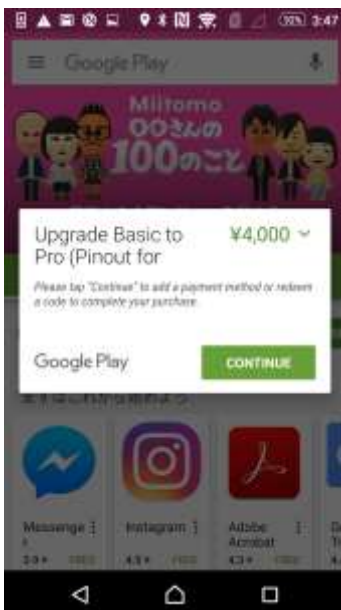

If you choose “input passcode”, you need to tear off the seal and scan the QR code printed on the warranty card or input the passcode manually.

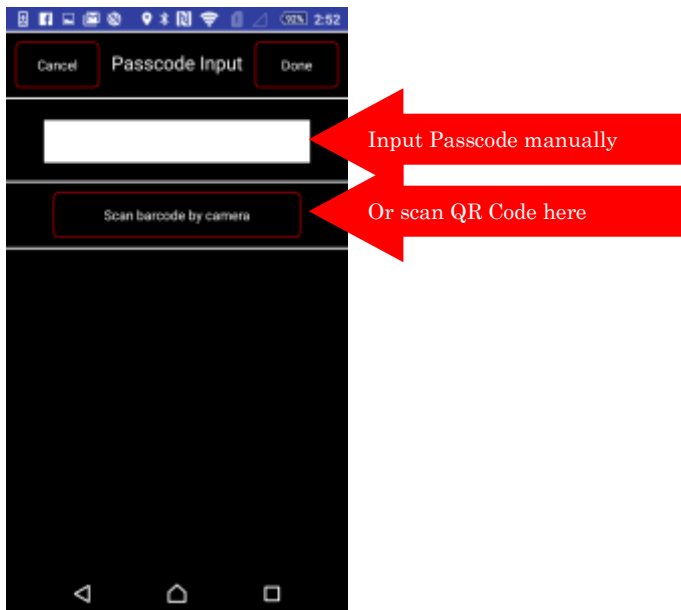

## Technical Support

Please send emails to following email address if you have any questions

[support@zesty.co.jp](mailto:support@zesty.co.jp)